

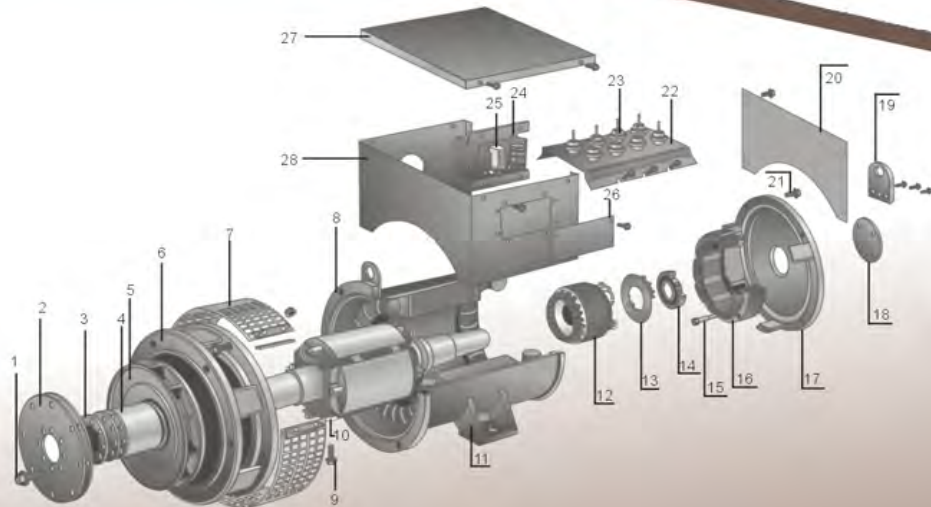

型号及功率MODEL & POWER

型号Model	额定功率 Power(1500rpm/50Hz)400V		额定功率 Power(1800rpm/60Hz)440V	
	KW	KVA	KW	KVA
SSG164A	6.5	8.1	8.2	10.2
SSG164B	8.8	11.0	11	13.8
SSG164C	10.8	13.5	13.5	16.9
SSG164D	12.8	16	16.0	20.0
SSG184E	18	22.5	23.0	28.8
SSG184F	22	27.5	27.5	34.4
SSG184G	25	31.3	30	37.5
SSG184H	30	37.5	37.5	46.9
SSG184J	32	40	40	50
SSG224C	34	42.5	42	52.5
SSG224D	40	50	50	62.5
SSG224E	48	60	56	70
SSG224F	58	72.5	70	87.5
SSG224G	68	85	78	97.5
SSG274C	80	100	94	118
SSG274D	91	106	110	138
SSG274E	112	140	134	168
SSG274F	128	160	152	190
SSG274G	141	170	170	213
SSG274H	160	200	196	245
SSG314C	200	250	235	294
SSG314D	236	295	280	350
SSG314E	260	325	315	394
SSG314F	304	380	365	456

SSG 184 Brushless Synchronous AC Alternators



- 01. BOLT
- 02. FLEX PLATE
- 03. DRIVE PLATE
- 04. FLEXOR
- 05. FAN
- 06. FRONT COVER
- 07. COVERING PLATE
- 08. STATOR WITH WINDING
- 09. BOLT
- 10. ROTOR WITH SHAFT

- 11. EARTHING TERMINAL
- 12. EXCITATING ROTOR
- 13. ROTARY RECTIFIER
- 14. BEARING
- 15. EXCITATING STATOR BOLT
- 16. EXCITATING STATOR
- 17. BACK SHIELD
- 18. BEARING COVER
- 19. EYEBOLT
- 20. TERMINAL BOX-END PLATE

- 21. BOLT
- 22. TERMINAL BOARD
- 23. TERMINAL POLE
- 24. AVR FRAME
- 25. AVR
- 26. TERMINAL BOX-SIDE PLATE
- 27. TERMINAL BOX-TOP COVER
- 28. TERMINAL BOX-FRONT PLATE

AR- ϕ AS通孔均布于 ϕ AT圆周
AR- ϕ AS through-hole uniformly distribute in ϕ AT circle

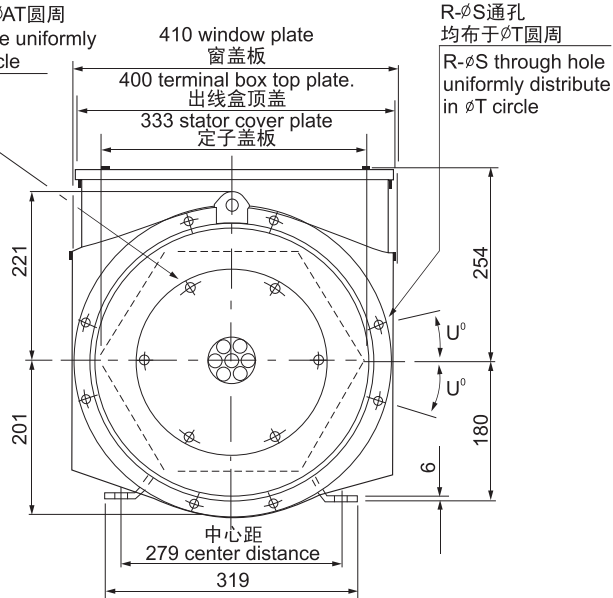

minimum 50 最小
air intake 进风口

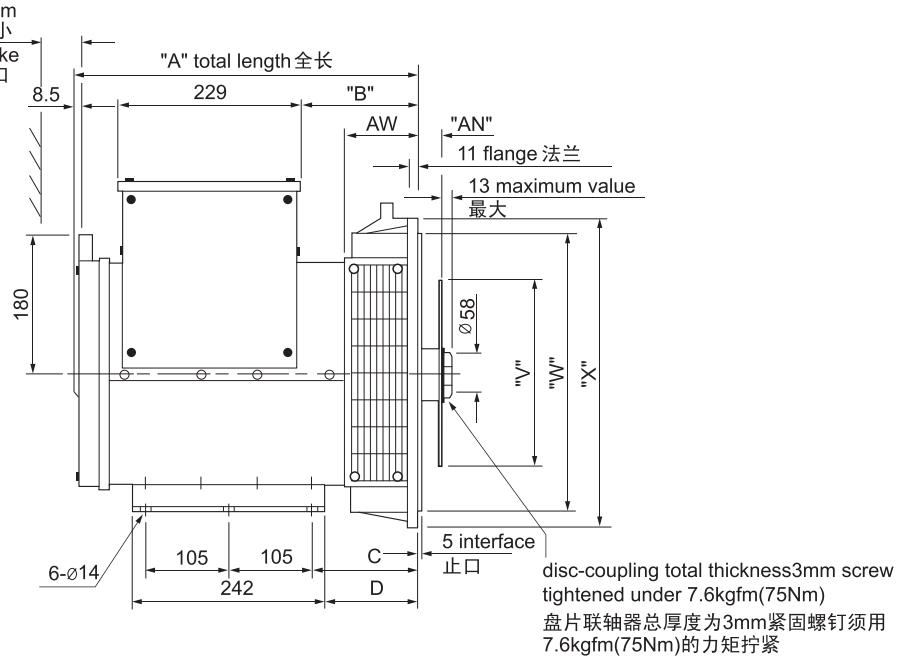

尺寸 (mm)					
S.A.E.NO.	AN	AR	AS	AT	V
6.5 [△]	30.16	6	8.7	200.0	215.8
7.5 [△]	30.16	8	8.7	222.2	241.2
8	61.9	6	11	244.5	263.4
10	53.98	8	11	295.3	314.2
11.5	39.68	8	11	333.4	352.3
14 [△]	25.4	8	13.5	438.2	466.5

FLANGE 法兰式过渡接套(单轴承)(仅适用于SLG184H/J铁心) (mm)							
S.A.E.NO.	C	D	R	S	T	W	X
1	220.3	204.3	12	12.7	530.2	511.1	553
2	206	190	12	11	466.7	447.6	490
3	206	190	12	11	428.6	409.5	451
4	206	190	12	11	381	361.9	453

FLANGE 法兰式过渡接套 (mm)									
S.A.E.NO.	AW	R	S	T	UO	W	X	C	D
2	132.3	12	11	466.7	15	447.6	489	172	156
3	105	8**	11	428.6	15	409.5	451	145	129
4	93	8	11	381.0	15	361.9	402	133	117
5	93	8	11	333.3	22.5	314.3	356	133	117
6*	124.7	8	11	285.8	22.5	266.7	308	164.7	148.7

TRANSPORTATION DATA 运输数据					
型号 Model	N.W(kg)	G.W(kg)	LXWXH(cm)	A	B
SKG 184E	120	133	84X59X75	431.5	147
SKG 184F	150	156	84X59X75	521.5	237
SKG 184G	156	172	84X59X75	521.5	237
SKG 184H	216	226	85X55X85	654.5	325
SKG 184J	226	236	85X55X85	654.5	325

注:*SAE6需加一厚31.7mm的过渡板,故"A"尺寸也相应增加31.7mm
**SAE3的8个孔分布于12等分的圆周上

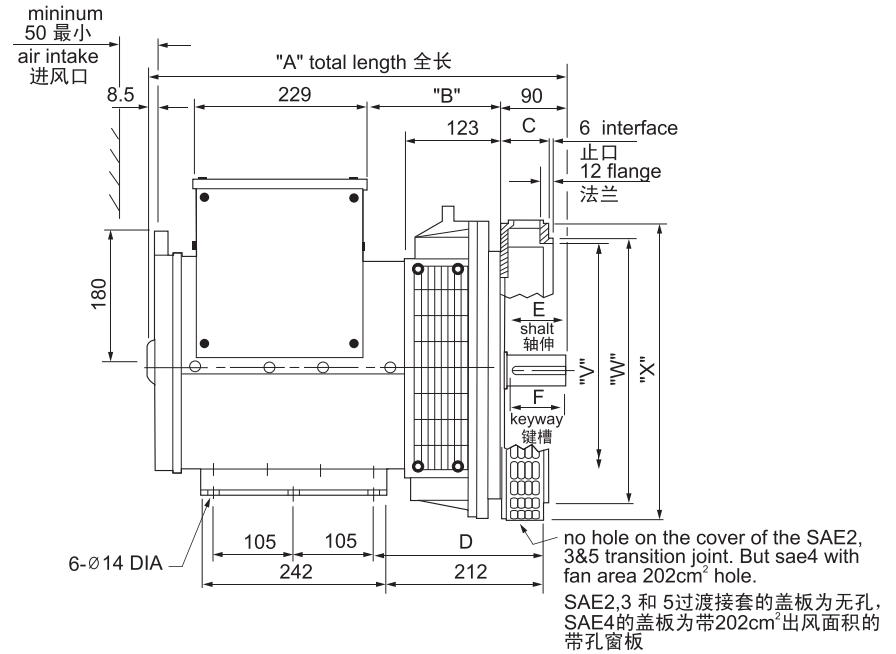
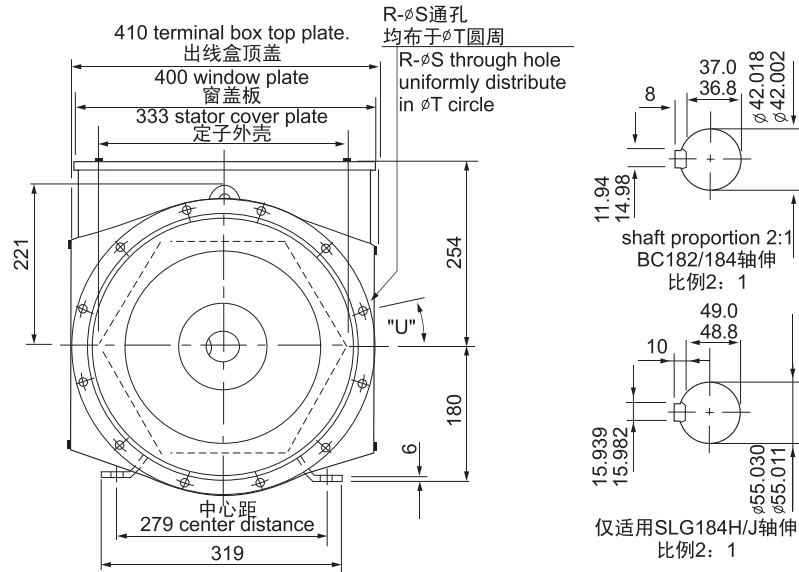

DIMENSION 尺寸

型号 Model	A	B	C	D	E	F
SKG 184E	551.5	177	65	228	82	77
SKG 184F	641.5	267	65	228	82	77
SKG 184G	641.5	267	65	228	82	77
SKG 184H	641.5	267	105	271	110	100
SKG 184J	641.5	267	105	271	110	100

TRANSPORTATION DATA 运输数据

型号 Model	N.W(kg)	G.W(kg)	LXWXH(cm)
SKG 184E	131	141	84X59X75
SKG 184F	154	164	84X59X75
SKG 184G	170	180	84X59X75
SKG 184H	220	230	85X55X85
SKG 184J	230	240	85X55X85

DISC COUPLING 盘片式联轴器

S.A.E.NO.	R	S	T	U ^o	V	W	X
1	12	12.7	530.2	15	500	511.17	553
2	12	11	466.7	15	432	447.6	495
3	12	11	428.6	15	396	409.5	451
4	12	11	381.0	15	352	361.9	403
5	8	11	333.3	22.5	301	314.3	356

注：SAE不适用于SKG 184H/J